

AKASO

# Keychain3

A C T I O N   C A M E R A

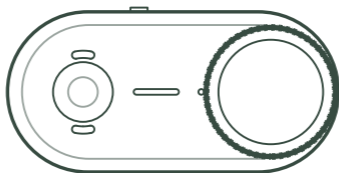

USER MANUAL

V1.0

# Contents

<b>Important Messages</b>	<b>03</b>	>>
<b>Waterproof Performance</b>	<b>05</b>	>>
<b>1. Specifications</b>	<b>06</b>	>>
<b>2. What's in the Box</b>	<b>08</b>	>>
<b>3. Your Keychain3</b>	<b>09</b>	>>
<b>4. First Use</b>	<b>11</b>	>>
(1) Install / Remove the Camera	11	
(2) Charging the Action Pod	12	
(3) Charging the Action Cam	12	
<b>5. Getting Started</b>	<b>13</b>	>>
(1) Powering On and Off	13	
(2) Turning Wifi On or Off	13	
(3) Recording Videos	14	
<b>6. Using Your Camera with AKASO GO App</b>	<b>15</b>	>>
(1) What You Can Do with the App	15	
(2) Downloading the AKASO GO App	15	
(3) Connecting the Camera via Wifi	16	
(4) App Overview	19	
<b>7. Transferring Files to a Computer</b>	<b>25</b>	>>
<b>8. Battery Maintenance</b>	<b>26</b>	>>
(1) Maximizing Battery Life	26	
(2) Battery Storage and Handling	26	
<b>9. Using with Accessories</b>	<b>27</b>	>>
(1) Magnetic Magnet Lanyard	27	
(2) Magnetic Clip Mount	28	

(3) Magnetic Quick-Release Mount	29	
10. How-to Video	30	>>
11. Troubleshooting	30	>>
Contact Us	30	>>

# Important Messages

Congratulations on your new AKASO Keychain3 Action Camera! We're sure you're excited to start using it, but please take a few moments to read this manual first. Doing so will help you get the most out of its features and ensure safe operation.

## Device Safety Notes

1. Do not use if you wear a pacemaker. This camera contains a strong magnetic module.
2. Do not attempt to dismantle, repair, or modify the device on your own.
3. Avoid charging the device for extended periods. While charging, keep the device away from children and pets to prevent accidents.
4. Ensure the camera operates within its recommended temperature range. Avoid prolonged exposure to extreme heat or cold, as this may reduce its lifespan.
5. Only the camera itself is waterproof. Keep the Action Pod dry at all times. Always ensure the USB cover is fully closed and the lens area is clean before submerging the camera.
6. After using the camera in saltwater, rinse it with fresh water and gently pat it dry with a soft cloth. Allow it to air dry completely before placing it back into the Action Pod.
7. This camera is a precision instrument. Handle it with care and avoid drops, strong impacts, or contact with sharp objects.
8. Handle the Action Pod carefully. Applying excessive force or impact may damage or deform the latches, causing malfunction.
9. Keep the contacts clean and dry. Dirt, corrosion, or debris on the charging contacts may affect charging performance.
10. Store the camera away from devices or objects with strong magnetic fields, such as motors or magnets.



### Accessory Safety Notes

1. Keep all accessories out of reach of children to prevent accidental swallowing or injury.
2. The camera, magnetic lanyard, magnetic clip mount, and magnetic quick-release mount contain magnets. Keep them away from pacemakers and other medical devices.
3. Avoid using accessories during high-intensity activities (such as running, jumping, or impact sports), as the camera may loosen or fall.
4. Always ensure the camera is properly secured before use.
5. Do not apply excessive force to any accessory to avoid damage.

# Waterproof Performance

The Keychain3 Action Camera features an IPX8 waterproof rating, allowing it to be submerged up to 3 meters (9.84 ft) without an external case.

**Note:** The Action Pod is not waterproof. Avoid exposing it to rain, water, or high humidity.

To ensure optimal waterproof performance of the Action Cam, please follow the guidelines below:

## Before use

- Ensure the USB cover is fully closed.
- Make sure the lens cover is clean and free from dust, sand, or other debris.
- Inspect the lens cover for any signs of damage. Replace it promptly if necessary.
- Check that the charging contacts are clean and free of corrosion.

## After use

- Rinse the camera thoroughly with fresh water to remove salt or residue.
- Soak the camera in fresh water for 5–10 minutes if used in saltwater.
- Gently shake or blow out any water from the microphone opening.
- Dry with a soft cloth and allow it to air dry completely before storage or reuse.

## Waterproof Care Guidelines

1. Avoid using heat sources (such as hair dryers) to dry the camera.
2. Do not use the camera outside the recommended temperature range (0°C to 45°C).
3. Store the camera in a cool, dry place.
4. Avoid using the camera in hot springs or high-temperature environments.
5. Keep the camera away from corrosive substances such as perfumes or cosmetics.
6. Handle the camera carefully to prevent damage from impacts or drops.
7. Never disassemble the camera, as this may compromise its waterproof sealing.



# 1. Specifications

## Action Cam

Power Input	5V – 1A
Video Resolution	4K
Lens	Wide-angle lens
Gyroscope	6-axis stabilization gyroscope
Wifi	Built-in 2.4GHz Wifi (up to 10m / 32.8ft)
Speaker	0.5 W
Storage	Built-in 64GB eMMC (No SD card support) <b>Note:</b> Actual usable storage is approximately 58.2GB.
Operating & Charging Temperature	0 °C to 45 °C (32 °F to 113 °F)
Storage Temperature	-20 °C to 60 °C (-4 °F to 140 °F)
Waterproof Rating	IPX8
Battery Capacity	490 mAh
Connectors	USB Type-C
Dimensions	58.6 × 28.6 × 26.7 mm
Weight	44.5g



**Action Pod**

<b>Power Input</b>	5V – 2A
<b>Operating &amp; Charging Temperature</b>	0 °C to 45 °C (32 °F to 113 °F)
<b>Storage Temperature</b>	-20 °C to 60 °C (-4 °F to 140 °F)
<b>Waterproof Rating</b>	Not waterproof
<b>Battery Capacity</b>	1300 mAh
<b>Connectors</b>	USB Type-C, charging contacts
<b>Dimensions</b>	69 × 40 × 21.5 mm
<b>Weight</b>	54g

## 2. What's in the Box



Keychain3  
Action Cam×1



Action Pod  
× 1



Magnetic Quick-  
Release Mount × 1



Magnetic Clip  
Mount × 1



Magnetic Lanyard  
× 1



USB-C Cable  
× 1



Quick Start Guide  
× 1



### 3. Your Keychain3

The Keychain3 consists of two main parts: the Action Cam and the Action Pod. The Action Cam has a built-in magnetic base and back plate for attachment to compatible magnetic accessories or metal surfaces. The Action Pod charges the camera, and its 1/4" threaded mount allows connection to tripods, selfie sticks, and other compatible accessories.

**Note:** The camera contains a strong magnetic module. Do not use it if you have a pacemaker or other implanted medical devices.

#### Action Cam

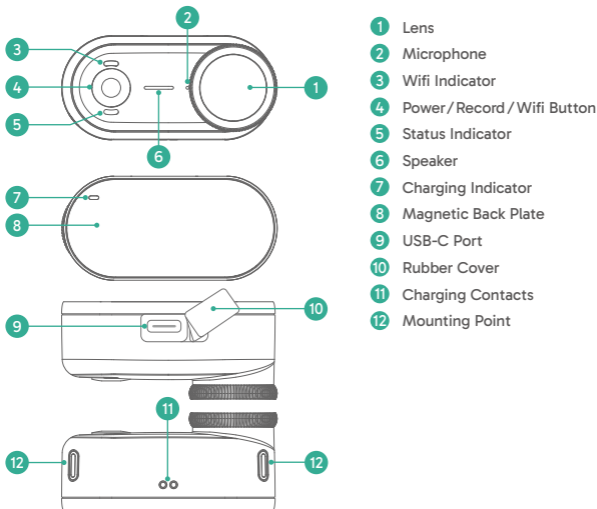

## Action Pod

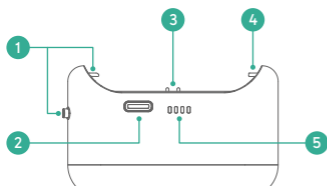

- 1 Release Button
- 2 USB-C Charging Port
- 3 Charging Contacts
- 4 Locking Clip
- 5 Battery Level Indicator
- 6 1/4" Mounting Thread

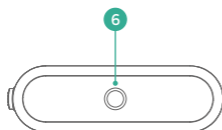

## 4. First Use

### (1) Install / Remove the Camera

#### Installing the Camera

**Tip:** Ensure the camera back and Action Pod indicator lights are on the same side, and the magnetic contacts are aligned.

Insert the camera into the fixed side of the Action Pod at an angle, and press it down toward the release button until you hear a "click."

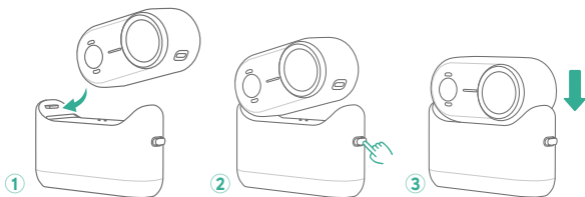

#### Removing the Camera

Press the release button to unlock, then lift the camera slightly from the release-button side to remove it.

#### Notes:

- Do not pull the camera straight up, as this may damage the locking mechanism.
- Handle the camera carefully to prevent it from dropping.



## (2) Charging the Action Pod

Connect the Action Pod to a USB adapter or computer using the included USB-C cable. The battery level indicators flash green while charging and remain solid green when fully charged. Once fully charged, disconnect the cable.

**Note:** The USB port on the Action Pod is for charging only and does not support data transfer.

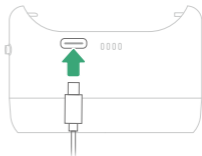

## (3) Charging the Action Cam

When the battery is low, the camera's charging indicator flashes red. If connected to the AKASO GO app, a low-battery notification will also appear.

You can charge the camera in the following two ways:

### Method 1: Using a USB-C Cable

Open the rubber cover and connect the camera to a USB adapter or computer using the USB-C cable. The charging indicator stays red while charging and turns off when fully charged. Once charging is complete, disconnect the cable and securely close the rubber cover.

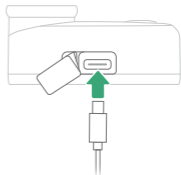

### Method 2: Using the Action Pod

Place the Action Cam properly into the Action Pod. The camera will begin charging automatically.

You can check the charging status using the battery level indicators on the Action Pod.

**Note:** When docked in the Action Pod, the camera will auto power off after 3 minutes and continue charging.

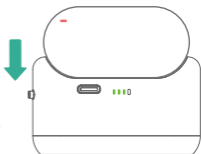

## 5. Getting Started

### (1) Powering On and Off

Press and hold the camera button for 2 seconds to turn it on. The status indicator will stay green.

Press and hold the button for 2 seconds again to turn it off.





**Note:** By default, the camera will automatically power off after 3 minutes of inactivity. This duration can be adjusted in the settings.

### (2) Turning Wifi On or Off

With the camera on, press the camera button twice to turn Wifi on.

Press the button twice again to turn Wifi off.



Wifi Status	Wifi Indicator
On / Ready	Flashing slowly 
Connected	Solid blue 
Off	Off



To preview the camera's live feed, connect it to the AKASO GO app via Wifi. Once connected, you can access the live feed, control the camera, adjust settings, playback, download, edit, and share videos directly from your phone. For more details, see [Using the Camera's Wifi & AKASO GO App](#).

### (3) Recording Videos

With the camera on, press the camera button to start recording. The status indicator flashes green to confirm recording has started.



Press the button again to stop recording. The status indicator turns solid green and a rapid triple beep sounds to confirm recording has stopped.

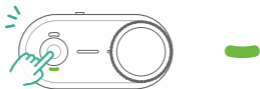

#### Notes:

- Photos can only be taken via the AKASO GO app.
- When Wifi is enabled, recording can only be controlled through the app. To record using the camera button, turn off Wifi first.
- If storage is full, the indicators will flash blue and green alternately five times and a warning tone will sound. Recording will not start.

## 6. Using Your Camera with AKASO GO App

### (1) What You Can Do with the App

1. View the camera's status, including battery level and remaining storage, on your phone.
2. Remotely control the camera, including starting/stopping video recording.
3. Adjust camera settings such as resolution, image stabilization, and photo/video modes.
4. Preview videos and photos stored on the camera.
5. Edit, save, or share videos and photos directly from your phone.

### (2) Downloading the AKASO GO App

- ① To sync your camera with the app, download the AKASO GO app from the App Store (iOS) or Google Play (Android) by searching for "AKASO GO". Alternatively, use the provided QR code:



AKASO GO



Android



iOS

- ② Some features may require an AKASO account, you can Creating An Account for the AKASO GO App (If you already have an account, log into the app directly.)

**Step 1:** Open the AKASO GO app, then tap "My" in the bottom right corner to enter the registration page.

**Step 2:** Tap "Join Now" to enter the required information for login, then tap the "Log in" option. Now you successfully create the app account.



### (3) Connecting the Camera via Wifi

To connect your Keychain3 to the AKASO GO app, first ensure the app has permission to access your Location and Local Network. Then follow the steps below.

- ① With the camera on, press the camera's button twice to turn on the camera's Wifi.



- ② Enter your phone's Wifi settings page, find the camera's Wifi SSID and tap on it, then enter the default password 1234567890 for connection.

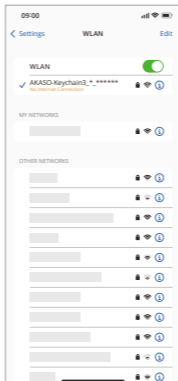

- ③ Open the AKASO GO app on your smartphone, tap "Device" at the bottom, then tap "Add Device" to add your camera.

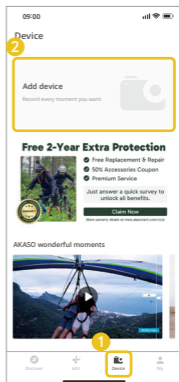

- ④ Select "Keychain3" from the list to establish a connection.

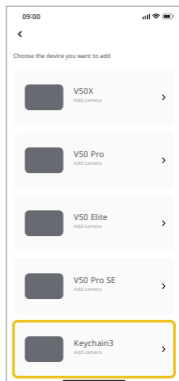

- ⑤ Tick "The above operation has been confirmed", and tap "Live Preview". Your camera will be connected to the AKASO GO app in seconds.

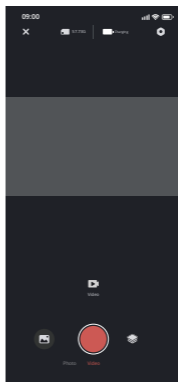

### Notes:

- If the camera's Wifi is enabled but no device connects within 3 minutes, Wifi will turn off automatically.
- If you cannot find the camera's Wifi, make sure it is turned on, disconnect your phone from other Wifi networks, toggle your phone's Wifi off and on, and then return to the AKASO GO app.
- While connecting the camera's Wifi, a "No Internet Connection" or "Weak Security" notification will appear since the phone's data is paused. However you can continue the connection.
- The camera cannot record while Wifi is active; use the app to control.

## (4) App Overview

### A. Live Preview & Camera Controls

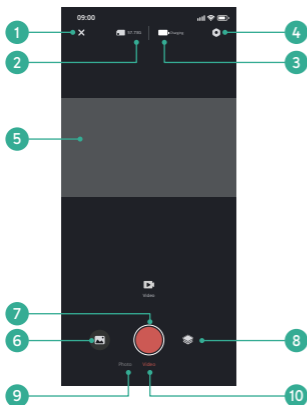

- 1 Disconnect from the app
- 2 Available Storage
- 3 Battery Status
- 4 System Settings
- 5 Live Feed
- 6 Album Access
- 7 Shutter
- 8 Resolution Setting
- 9 Photo Modes
- 10 Video Modes

### Quick Resolution Settings

**Video Resolution:** In Video mode, tap the icon  to select the desired resolution: 4K30 (default) / 2.7K30 / 1080P30.

**Photo Resolution:** In Photo mode, tap the icon  to select the desired resolution: 20MP (default) / 5MP.

**Tip:** Higher resolutions capture more detail but use more storage.

## B. Album

Manage your media files stored on the camera.

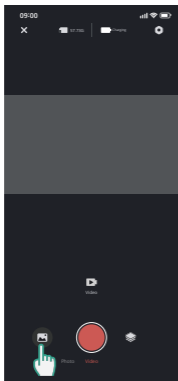

### • Viewing Files

- ① Tap the Album icon (bottom left) to view videos and photos stored on the camera.
- ② Swipe up to view all files, then tap a file to play.





### • Downloading Files

**Tip:** To download files from the camera to your phone, first allow the app to access your phone's album in Settings > AKASO GO > Photos > All Photos.

- ① Open the Album, tap Select icon (top right) , and choose one or more files .
- ② Tap Download icon (bottom right)  and confirm.
- ③ The file(s) will be saved to your phone's gallery.

## • Deleting files

- ① Open the Album, tap Select icon (top right) , and choose one or more files .
- ② Tap Delete icon (bottom left)  and confirm.

**Note:** Do not change Wifi settings or disconnect from the app while downloading or deleting files.

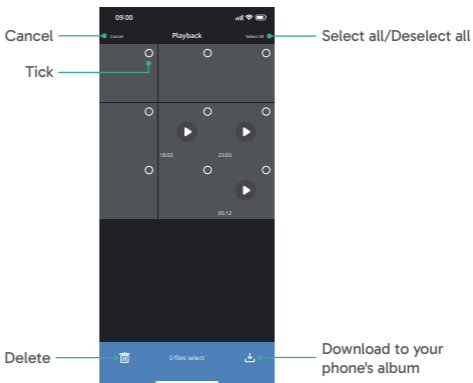

## C. Camera & System Settings

All video and system settings are configured through the app once the camera is connected. Tap the Settings icon (upper right)  to access menus.

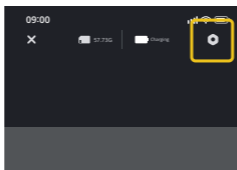

### • Video Settings Menu

#### 1. Video Sound (Audio Recording)

On (default) / Off

Enable or disable audio capture during video recording.

#### 2. Looping Video

Off (default) / On

When enabled, the camera automatically deletes the earliest footage on its internal storage once it is full for continuous recording.

#### 3. Duration

10s / 15s / 1min / 3min / 5min (default)

Sets the recording segment length for both Normal Video and Looping Video modes.

#### 4. Image Stabilization

Off (default) / On

Image Stabilization can efficiently smooth out the lens shakes, resulting in smooth and pristine videos. This feature is ideal for capturing scenes involving activities like riding, skating, and handheld use.

## 5. Display (Aspect Ratio)

16:9 (default) / 9:16

The camera supports landscape shooting only. Selecting 9:16 will crop the field of view vertically.

### • System Settings Menu

#### 1. Date Stamp

On (default) / Off

With this feature enabled, the camera will add a time watermark on the captured videos and photos.

#### 2. Flip 180°

Off (default) / On

Flips the video or photo 180° so that footage recorded appears correct.

#### 3. Frequency

50Hz / 60Hz (default)

Select the frequency for which the video recorded or played back on the TV according to your region. If you live in the northeastern area, please set the power frequency to 60Hz. If you live outside this area, set it to 50Hz. Be sure to select the correct format to avoid the light waves while capturing indoors.

#### 4. Auto Power Off

Off / 3min (default) / 5min / 15min

Set the duration of inactivity after which the camera automatically powers off. If not operated within the chosen duration, the camera will shut down.

#### 5. Format

Cancel / Confirm

Regularly clears all files from the camera's internal storage to maintain optimal performance.

**Note:** All saved videos and photos will be deleted. Make sure important files are backed up before proceeding.

## 6. Reset

Cancel / Confirm

This option resets all settings to their default values.

**Tip:** If the camera is not functioning properly, a reset may help. After resetting, the camera will automatically power off. Please turn it on again manually.

## 7. Camera version

View version number about the camera.

## 7. Transferring Files to a Computer

You can transfer files for playback or editing using a USB data cable.

**Step 1:** Connect the camera to your computer via its USB port.

**Step 2:** Access the camera storage on your computer and transfer files as needed.

### Notes:

- To transfer files via the camera's USB port, remove it from the Action Pod first.
- Use a USB data cable (not just a charging cable) to enable data transfer.
- Do not use the device for shooting during file transfer.
- Do not power off the device while transferring files.
- If the transfer is interrupted, disconnect and reconnect the USB-C cable, then try again.



## 8. Battery Maintenance

### (1) Maximizing Battery Life

1. Fully charge the camera and the Action Pod before first use.
2. Turn off the camera when not in use, and disable Wifi if not needed.
3. Enable the Auto Shutdown feature to save power.
4. To avoid potential damage, use only AKASO charging cables.
5. For general use, consider recording at lower resolutions to conserve battery.
6. Operate the camera within its specified temperature range. Exposure to extreme heat or cold may impair performance and shorten the device's lifespan.

### (2) Battery Storage and Handling

1. Store the devices in a dry, cool place, away from direct sunlight or heat sources.
2. Avoid placing them near metal objects to prevent short circuits.
3. Do not expose the devices to extreme cold or strong static/magnetic fields.
4. If the device shows abnormal behavior (odor, overheating, color change, distortion), stop using immediately.
5. Never dispose of the devices in fire.



## 9. Using with Accessories

The Keychain3 camera supports various accessories to enable flexible mounting and diverse shooting scenarios.

### (1) Magnetic Magnet Lanyard

Enjoy a hands-free, first-person perspective for immersive recording.

- ① Adjust the lanyard length using the adjustment buckle.
- ② Wear the lanyard inside your clothing, with the camera icon facing forward.
- ③ Adjust the lanyard position to achieve the desired shooting height.
- ④ Attach the camera to the outside of your clothing, aligning it with the internal magnet.

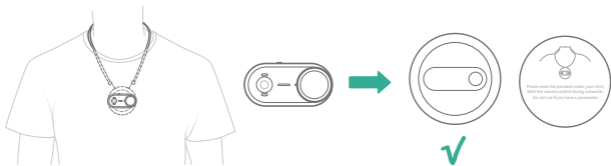

#### Notes:

- The camera supports landscape recording only.
- Do not use the lanyard with thick clothing, as this may weaken the magnetic hold and cause the camera to fall.
- For safety, keep the lanyard out of reach of children and ensure it is used only under adult supervision.



## (2) Magnetic Clip Mount

Ideal for capturing stable, hands-free footage from caps, backpacks, or similar gear.

- ① Align the camera lens with the clip's curved opening, then attach it magnetically.
- ② Open the clip and attach it to a cap brim, backpack strap, or pet collar, etc.
- ③ Rotate the mounting base to adjust the shooting angle as needed.

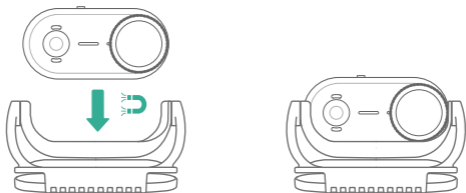

### Notes:

- Be careful when opening the clip to avoid pinching your fingers or damaging the mechanism.
- Rotate the clip mount gently to prevent damage.

### (3) Magnetic Quick-Release Mount

Perfect for quick mounting and stable shooting setups.

- ① Press and hold the buckles on both sides of the mount to open them.
- ② Place the camera onto the mount and release the buckles to lock it in place.
- ③ Gently shake the camera to confirm it is securely attached.
- ④ Use the 1/4" mounting thread to attach the mount to accessories such as a tripod or selfie stick.

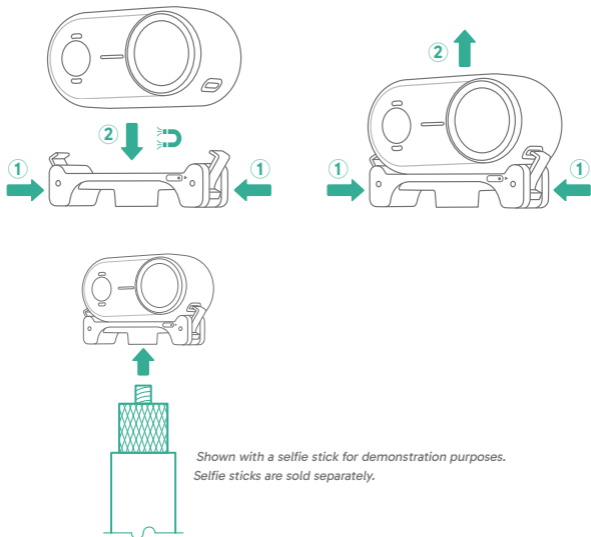

**Note:** When attaching the mount to other accessories, ensure all connections are secure to prevent the camera from loosening or falling.

## 10. How-to Video



[Watch Now](#) 

Scan the QR code or click the link to watch the Keychain3 and its accessories usage video.

## 11. Troubleshooting

If your Keychain3 camera freezes, press and hold the camera button for about 10 seconds to perform a hard reset.

For in-depth troubleshooting guidance, please refer to AKASO official technical support page: <https://support.akasotech.com/hc/en-us>.

## Contact Us

 (888) 466-9222 (US)

 [cs@akasotech.com](mailto:cs@akasotech.com)

 [www.akasotech.com](http://www.akasotech.com)

For any inquiries about AKASO products, please feel free to contact us.  
We will respond within 24 hours.

